

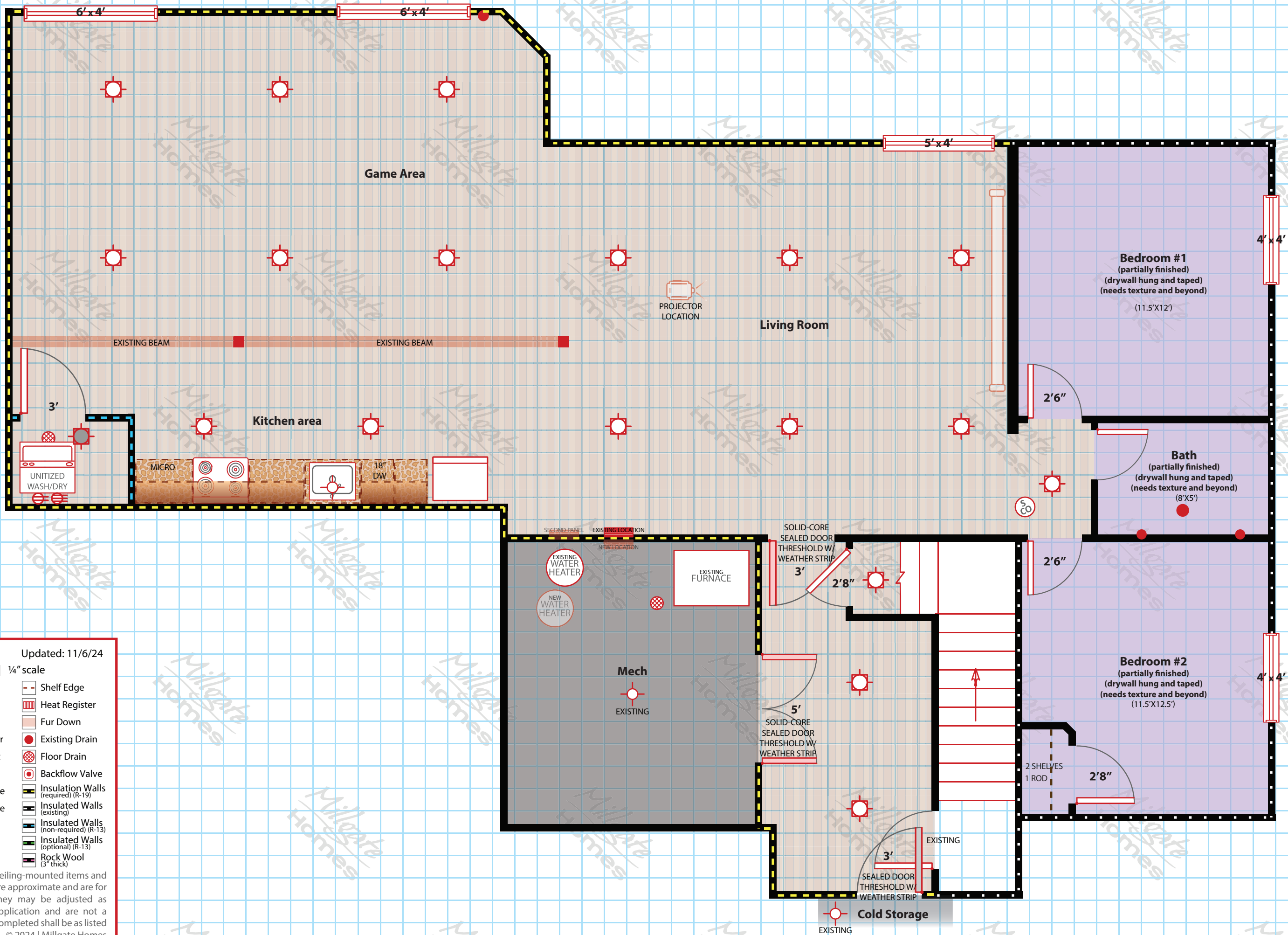

Future walk-out door location



Jones

930 sq.ft. | 92" ceilings | 1/4" scale

Updated: 11/6/24

LVP/LVT Flooring

Tile Flooring

No Flooring

Unfinished Room

Rubber Flooring

Painted Flooring

Glue-down Carpet

Concrete Cut

Granite

Cabinet

Cultured Marble

Ceiling Light

Wall Light

LED Disc-Light

Smoke Detector

Smoke/CO Unit

Exhaust Fan

110V Receptacle

220V Receptacle

GFI Receptacle

Switch

Breaker Panel

Shelf Edge

Heat Register

Fur Down

Existing Drain

Floor Drain

Backflow Valve

Insulation Walls (required) (R-19)

Insulated Walls (existing)

Insulated Walls (non-required) (R-13)

Insulated Walls (optional) (R-13)

Rock Wool (3" thick)

\*Cabinetry configurations/styles, locations of ceiling-mounted items and other features, measurements or dimensions are approximate and are for concept and visualization purposes only; they may be adjusted as necessary to accommodate for real-world application and are not a declaration of work to be done; All work to be completed shall be as listed in the bid documentation.

© 2024 | Millgate Homes