

Prince

585 sq.ft. | 92" ceilings | 1/4" scale

Updated: 03/13/24

LVP/LVT Flooring	Ceiling Light	Shelf Edge
Tile Flooring	Wall Light	Insulation Walls (required) (R-13)
No Flooring	Recessed Light	Insulated Walls (non-required) (R-13)
Unfinished Room	Semi-flush Light	Insulated Walls (existing)
Rubber Flooring	Smoke Detector	Rock Wool (R-15)
Painted Flooring	Smoke/CO Unit	Heat Register
Vinyl Flooring	Exhaust Fan	Breaker Panel
Glue-down Carpet	110V Receptacle	Furr Down
Granite	220V Receptacle	Existing Drain
Cultured Marble	GFI Receptacle	Floor Drain
Cabinet	Switch	Concrete Cut

*Cabinetry configurations/styles, locations of ceiling-mounted items and other features, measurements or dimensions are approximate and are for concept and visualization purposes only; they may be adjusted as necessary to accommodate for real-world application and are not a declaration of work to be done; All work to be completed shall be as listed in the bid documentation. © 2023 | Millgate Homes

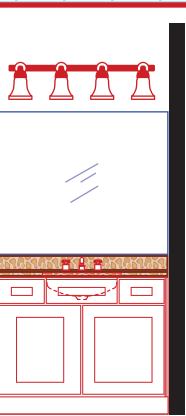

42" Vanity