

Stapler

575 sq.ft. | 92" ceilings | 1/4" scale

Updated: 7/29/24

	LVP/LVT Flooring		Ceiling Light		Shelf Edge
	Tile Flooring		Wall Light		Heat Register
	No Flooring		LED Disc-Light		Fur Down
	Unfinished Room		Smoke Detector		Existing Drain
	Rubber Flooring		Smoke/CO Unit		Floor Drain
	Painted Flooring		Exhaust Fan		Backflow Valve
	Glue-down Carpet		110V Receptacle		Insulation Walls (required) (R-19)
	Concrete Cut		220V Receptacle		Insulated Walls (existing)
	Granite		GFI Receptacle		Insulated Walls (non-required) (R-13)
	Cabinet		Switch		Insulated Walls (optional) (R-13)
	Cultured Marble		Breaker Panel		Rock Wool (3" thick)

*Cabinetry configurations/styles, locations of ceiling-mounted items and other features, measurements or dimensions are approximate and are for concept and visualization purposes only; they may be adjusted as necessary to accommodate for real-world application and are not a declaration of work to be done; All work to be completed shall be as listed in the bid documentation.

© 2024 | Millgate Homes

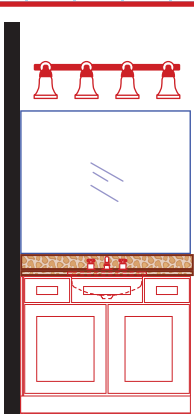

42" Vanity